

# WP Series

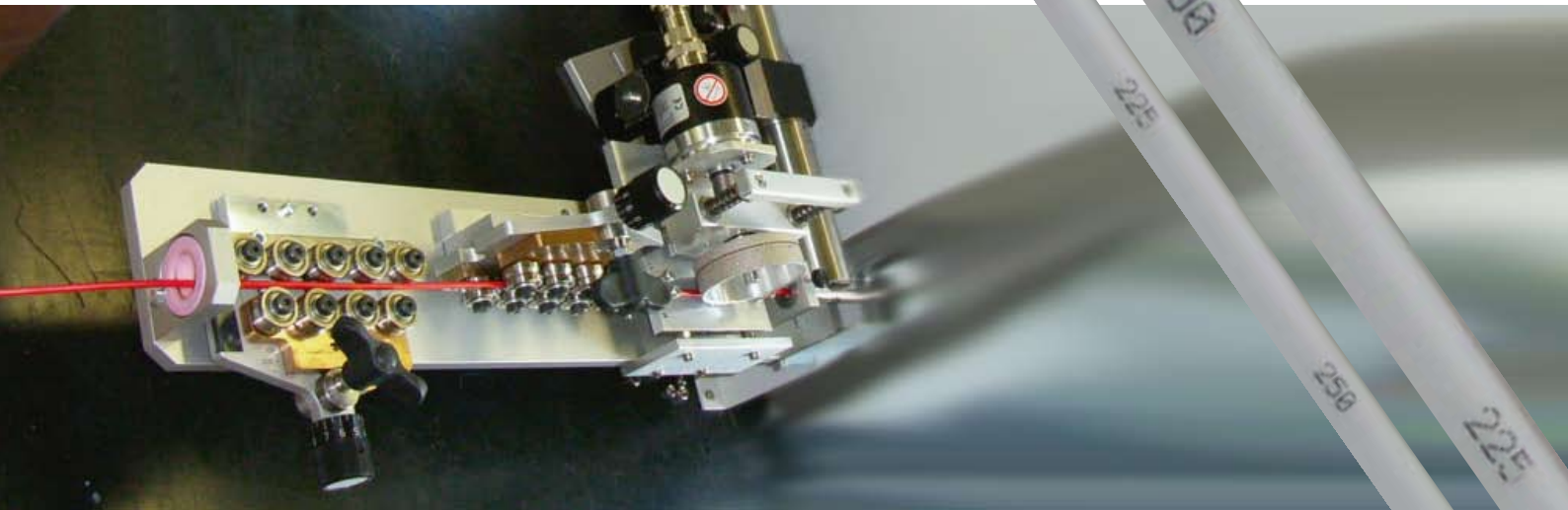

## **Easy to operate & Efficient**

The innovative marking solution for positioned printing  
in wire and cable processing

# Highlights

## Wire Processing Printer

Innovative and specially designed for the requirements in the wire processing industry

- > For use with all wire processing machines
- > Integrated control for positioned wire printing
- > No additional hardware necessary
- > Accurate positioning of the code
- > Easy integration
- > Smooth change of printing texts and parameters
- > Downwards compatible to CS Series:  
Use as standard printer possible

6th 3m		TEXT		⊙	
Text [WP Text, CB 1]:				Parameters / Buffer Order	
Job 1	Puffer:	<input type="text" value="1"/>	Position:	<input type="text" value="10"/>	mm
Job 2	Puffer:	<input type="text" value="2"/>	Position:	<input type="text" value="50"/>	mm
Job 3	Puffer:	<input type="text" value="3"/>	Position:	<input type="text" value="100"/>	mm
Job 4	Puffer:	<input type="text" value="4"/>	Position:	<input type="text" value="150"/>	mm
Job 5	Puffer:	<input type="text" value="5"/>	Position:	<input type="text" value="200"/>	mm
Job 6	Puffer:	<input type="text" value="6"/>	Position:	<input type="text" value="250"/>	mm
Job 7	Puffer:	<input type="text" value="7"/>	Position:	<input type="text" value="400"/>	mm
Confirm with <ENTER>, Cancel with <ESC>					

USER INTERFACE AT PRINTER

## Functionality

### Integrated control

for optimum production line efficiency

- > Only the impulses of the cutting machine and the encoder are necessary for positioned printing
- > The printer receives the relevant printing data either directly via the user interface at the printer or via the easy to use application software WPV
- > The printer controls the complete printing process and takes care of the correct text selection and text positioning
- > Up to 7 different positions can be marked with up to 7 different texts
- > Position input in mm or inch
- > Several counters possible per print job
- > Cable length compensation: The printer automatically compensates discrepancies in length caused by slippage, etc.

## Application

### Positioned wire printing

Individual, easy to operate and efficient

- > Suitable for use with new cable processing machines as well as for retrofitting existing machines
- > Flexible use at different production lines
- > Designed for the positioned printing of wires of the same lengths with the same marking
- > Print on both sides of the wire possible by simultaneous use of two printheads (ring marking)

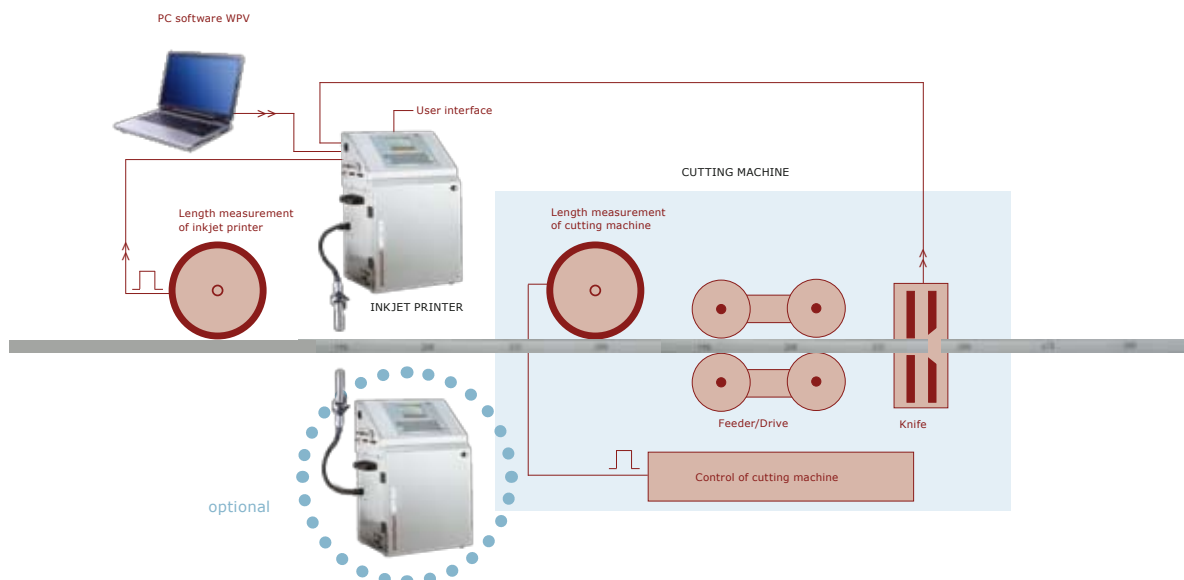

# Operation

## WPV & WPH

Easy to use PC software to control several printing jobs

- > Input of printing data via user interface directly at the printer or via the application software WPV which is provided as standard
- > To control several printers with different texts, it is recommended to use the software which clearly displays the different printing jobs and allows for easy editing and administration of the texts
- > For marking of complete wire harnesses we recommend the use of the optionally provided application software WPH



Standard application software WPV

## Advantages of software WPV & WPH:

- Windows interface
- WYSIWYG display for print preview
- Easy set-up and administration of print texts at PC
- Predefined fields for logos, counters, texts, date & time
- Print areas can be organised freely
- Integrated data base allows for extremely fast access to stored printing texts
- List administration allows for fast change of printing jobs
- Fast data transfer (TCP/IP)
- Almost unlimited memory capacity
- Bilingual (German/English)
- Simultaneous control of 2 printers
- Standardised operation of both printer models (WP 405 & WP 407)
- In case of printer replacement printing texts are stored and do not need to be recreated



Optional application software

# Marking

**Text, symbol and logo print**  
Fast, accurate and reliable

- > Different texts per wire, unlimited repeatable
- > Free positioning of all texts
- > Character width and character height adjustable
- > Combination of different character heights
- > Bold print
- > Chimney print
- > Logos to be freely defined

# Characteristics

- > Compatible with all wire processing machines
- > Simultaneous use of 2 print heads (ring marking)
- > Minimum print height: 0.8 mm
- > Minimum cable diameter: 1 mm
- > Cable length: 10 mm to 50 m
- > Positioning accuracy: +/- 2 mm (at printing speeds up to 4 m/s)
- > Cable length compensation
- > Maximum distance printhead - knife: 2 m
- > Up to 7 printing positions per cable
- > Position input in mm or inch
- > Matrix per position freely selectable
- > Text length: 64 characters per print position
- > Individual character width adjustable for each text
- > Several counters per print job possible
- > Application software WPV provided as standard

## One inkjet printer, thousands of possibilities

- > The WP Series reflects Wiedenbachs longterm experience and expert know-how in cable and wire processing and is designed to match the special requirements in this sector
- > Our wide range of inks guarantees excellent marking conditions for a high quality print result with optimum contrast and excellent adherence properties on various substrates
- > WP Series is downwards compatible to CS Series and can therefore flexibly be used as a standard printer (with full functional range of CS Series) at different production lines with different coding requirements

# Accessories

- > Application software WPH (for marking of wire harnesses)
- > Indication light for status display
- > Cable guiding system (different versions)
- > Encoder
- > Condenser
- > Trolley table
- > Aircondition
- > Hand sliding table (for plug printing)



Please refer to our accessories catalogue for a detailed listing.

Your local Wiedenbach representative:

Technical data subject to change without prior notice.

**WIEDENBACH**  
INDIVIDUAL INKJET MARKING SOLUTIONS

Wiedenbach Apparatebau GmbH  
Gewerbestr. 13, 78345 Moos, Germany  
Tel +49 (0) 7732 99 44 77, Fax +49 (0) 7732 5 24 38  
sales.support@wiedenbach.com, www.wiedenbach.com

 **DOMINO** GROUP COMPANY